

Ground Floor

Collaborative Zone

- 1 The Circle
- 2 Study Booths 1-10
- 3 The Lounge
- 4 Hemsley Learning Suite
- 5 Fini Family Terrace
- 6 Quobba Gnarning Cafe
- 7 Dowland Tech-Free Zone
- 8 Collaborative Desks
- 9 Whiteboard Desks
- 10 Vending Machines
- 11 PCs
- 12 Information Desk
- 13 High Demand
- 14 Returns
- 15 Dickinson Resource Room
- 16 Bathrooms and Showers
- 17 Eley Entrance

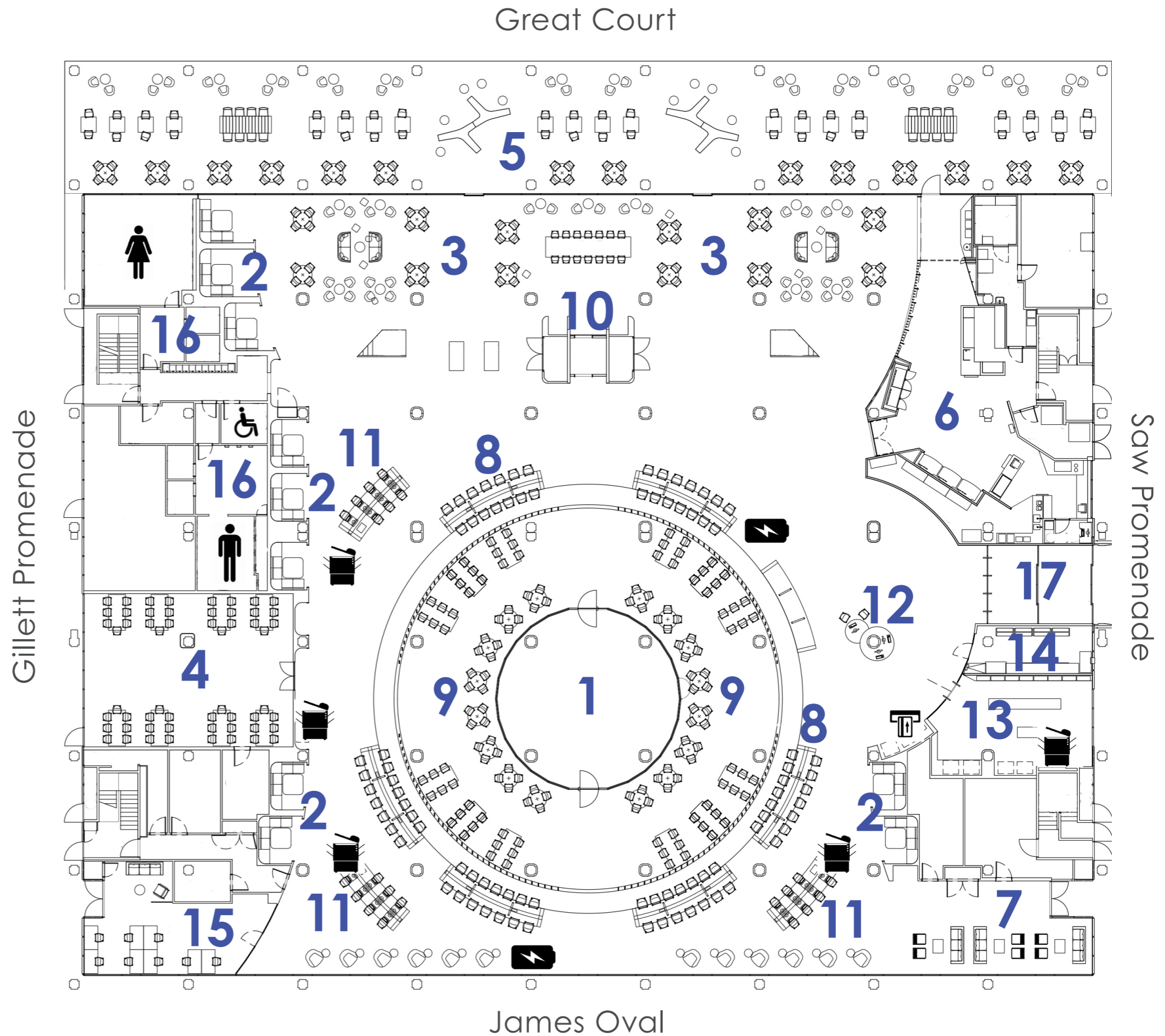

First Floor

Quiet Zone

- 1 Group Study Room 1
- 2 Group Study Room 2
- 3 Entrance
- 4 Staff Workroom
- 5 Staff Meeting Room
- 6 Sensory Room
- 7 Parents Room
- 8 Library Consultation Room
- 9 Training Room
- 10 Birks Room
- 11 Executive Meeting Room

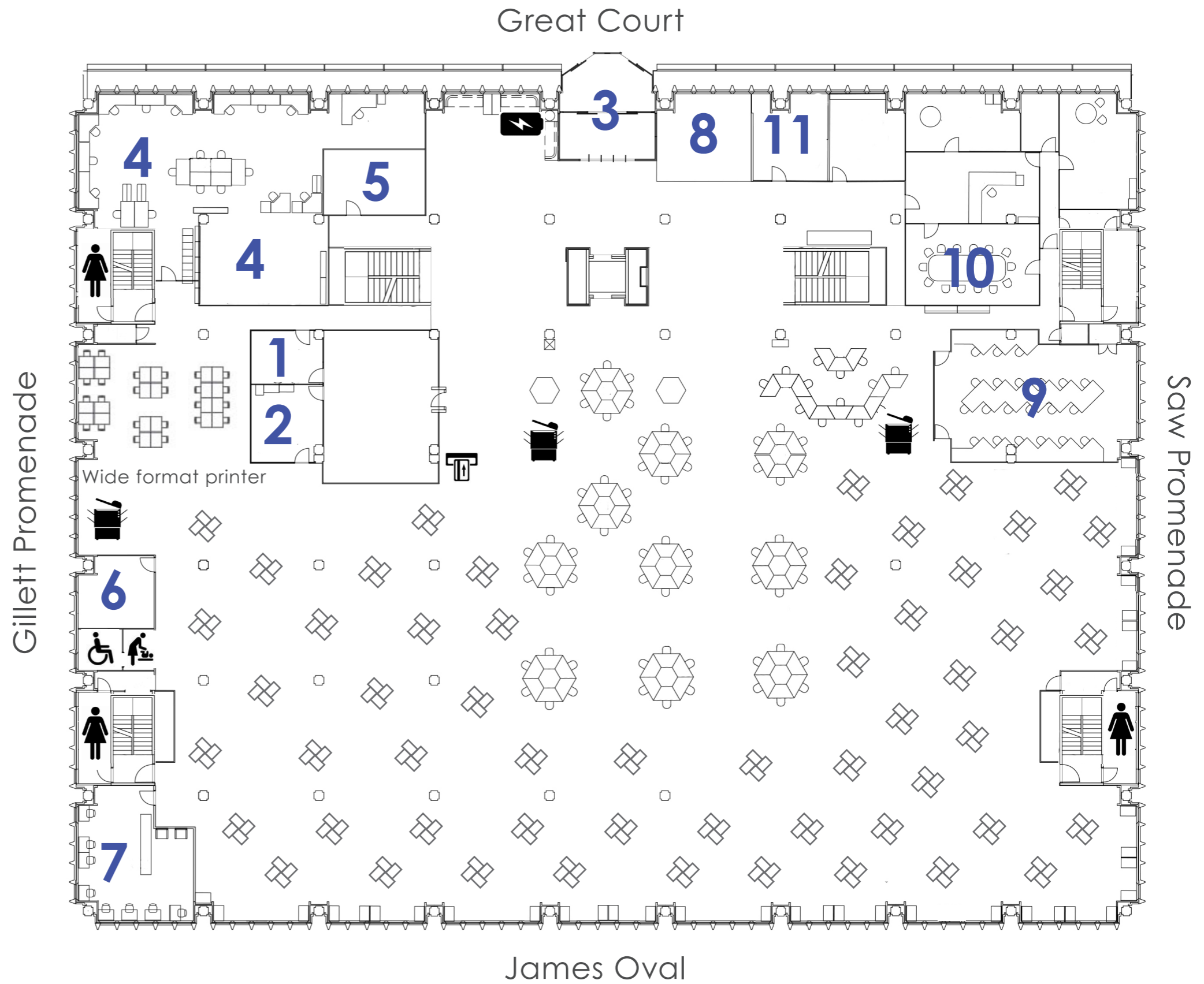

Second Floor

Silent Zone

- 1 Staff Workroom
- 2 Unisex / Accessible Toilet
- 3 Conference Room
- 4 Dispatch
- 5 Special Collections
- 6 Archives
- 7 Postgraduate Study Area

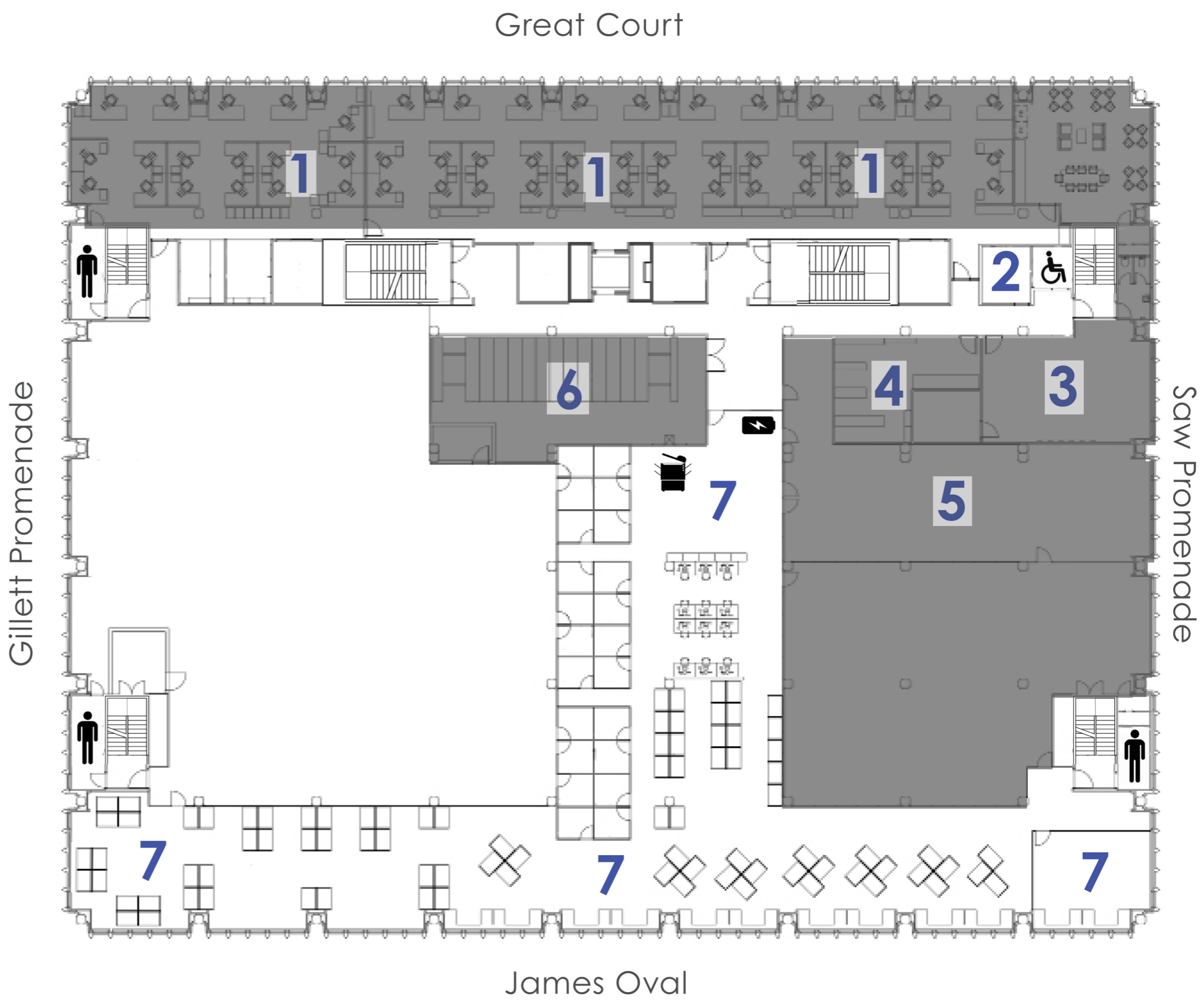

Third Floor

Silent Zone

Great Court

- 0 000 - 099
computer science, information, general
- 1 100 - 199
philosophy, psychology
- 2 200 - 299
religion
- 3 300 - 399
social sciences
- 4 400 - 499
language
- 5 Chinese, Japanese Korean
collection
- 6 Audio Visual
collection
- 7 700 - 799
arts, recreation
- 8 800 - 899
literature
- 9 900- 999, Quartos, Folios
geography, history
- 10 [P] Journals
periodicals
- 11 [Q]Quartos 000 - 899, [F]Folios 000 - 899
larger items
- 12 Music collection
music scores, choral sets, theses
- 13 AV equipment
VCR, DVD player, cassette player, vinyl record player

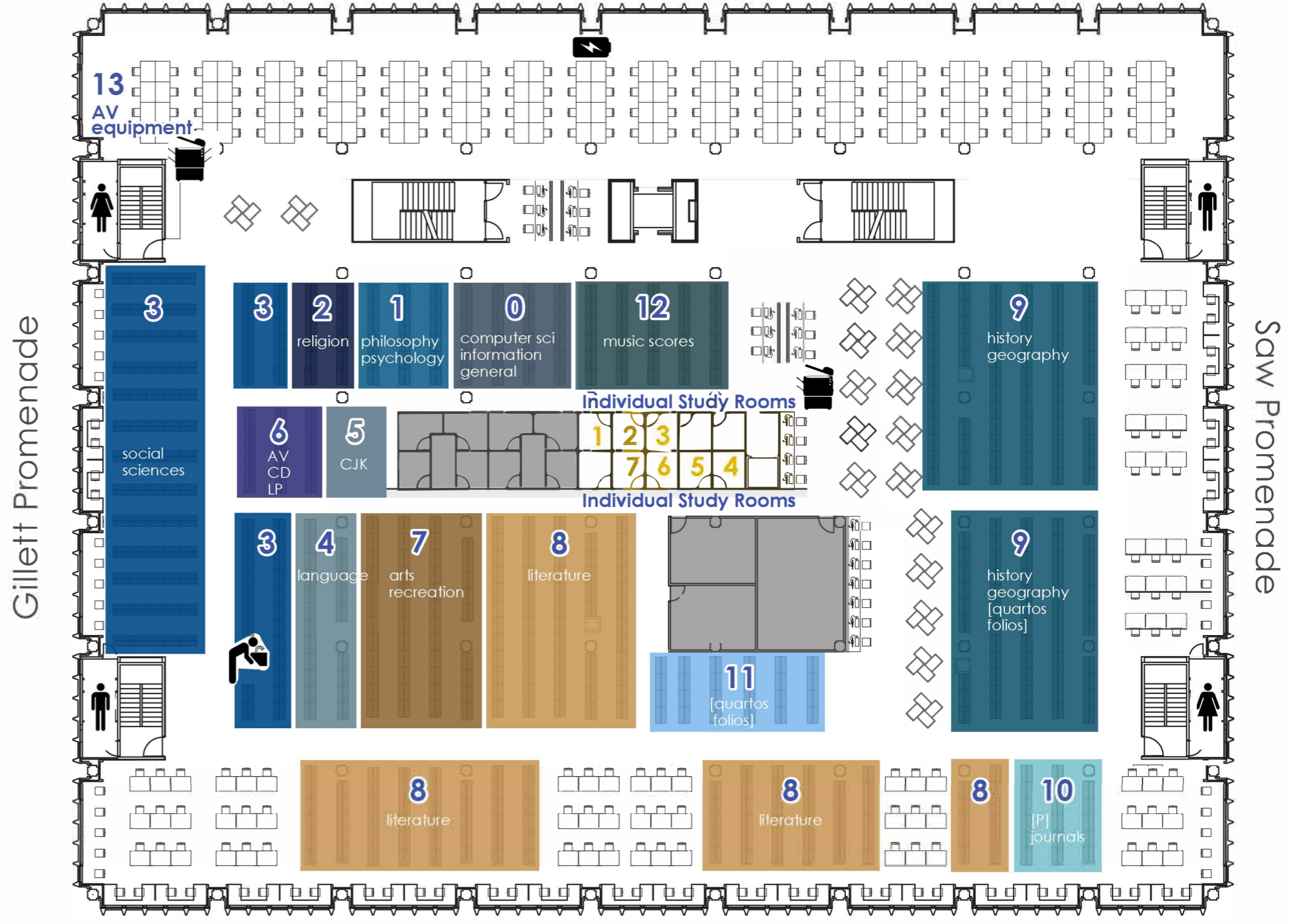

Gillett Promenade

Saw Promenade

James Oval

